



Conejos County Land Use Office

PO Box 197 / Conejos CO 81129
(719) 376-2014 / Fax (719) 376-6769

Permit No.
CP-
Renewal No.
CP-

Application for Construction Permit

Applicant, Last name First name

Mailing Address City State Zip

Telephone: Home Cell Email

Land owner, if different than applicant

Description of Property: Quarter Section Township Range Subdivision Lot No. Block No.

Size of Property/Parcel: Schedule/ Parcel No.

Physical/Site Address:

No. of existing structures: No. of dwelling units: Description:

Zone District: Rural Ag Residential PUD Community/Town Site Commercial Industrial

Does the site slope 20% or more? No Yes %

Contractor/Builder Telephone Email

Start Date: Completion Date (Permit valid for 1 year, renewal required before end of year.)

Describe your construction plans:

RESIDENCES: New Site-Built Residence Includes IBC modular homes on foundations.

Dimensions: x Total square feet bedrooms bathrooms Height

Mobile or Manufactured Home: Single Double Triple Park Model

Dimensions: x Total square feet bedrooms bathrooms

Dealer/Individual seller

Year Make & Model VIN No.

Addition to existing residence - Description & dimensions

UNOCCUPIED BUILDINGS: Dimensions: x Total square feet Height:

Business/Commercial Structure:

Accessory Building: Enclosed Not Enclosed:

Addition/Expansion: Enclosed Not Enclosed:



Sample of Site Plan for Construction Permits

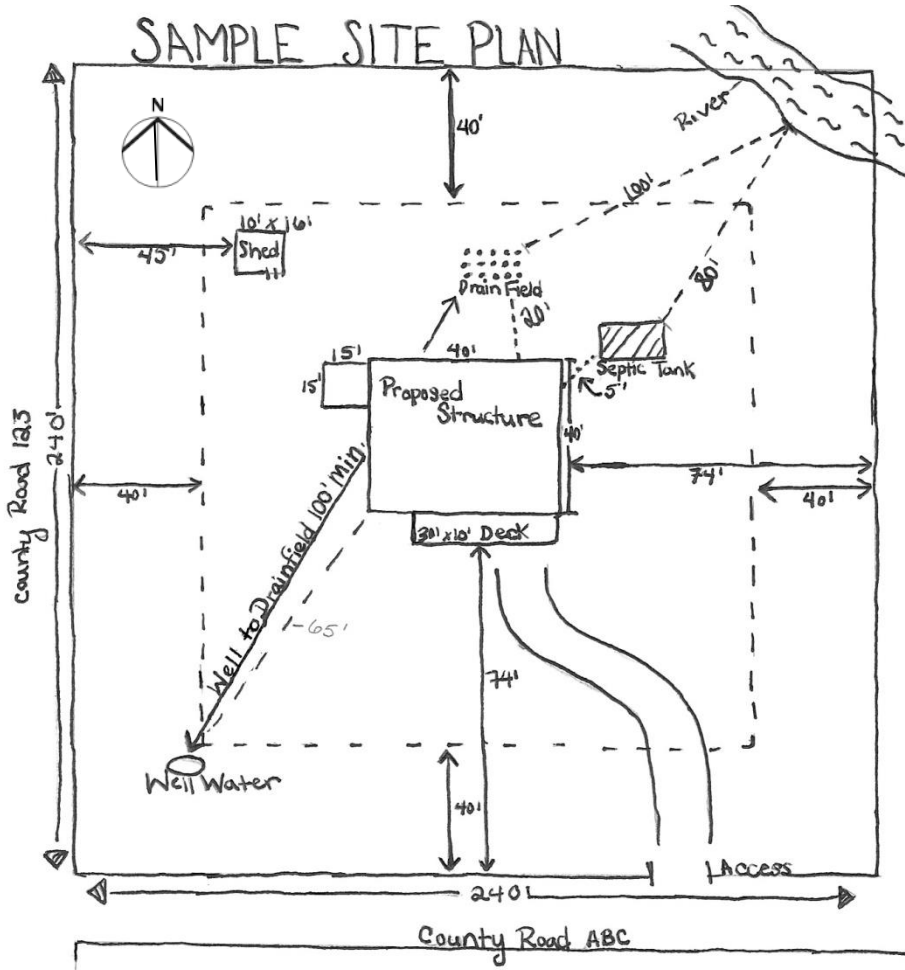

- North Arrow
- Property boundary lines
- Setback & setback boundary lines.
- Proposed/ Existing location of:
  - All structures & their distances from lot lines
  - All roads, railroads, irrigation ditches, utility easements & rights-of-way
  - Water source & water lines.
  - Wastewater/septic system & leach field/ sewer lines
  - Distance from drain field to well
- Significant on-site features: Drainages, wetlands, ditches, rock outcrops, dams, reservoirs
- Other information requested by the Land Use Administrator

**CONSTRUCTION SETBACKS:**

Any building/structure that is 120' square feet & larger must comply per zone district regulations.

Agricultural Zone District:	Front – 40'	Side – 40'	Rear – 40'	
Rural Zone District:	Front – 40'	Side – 40'	Rear – 40'	
Residential District:	Front – 25'	Side – 8'	Rear – 25'	Road/Street Corner – 25'
Community Town Site District	Front – 25'	Side – 8'	Rear – 25'	Road/Street Corner – 25'
Commercial District	Front – 25'	Side – 10'	Rear – 20'	Road/Street Corner – 25'
Industrial District	Front – 50'	Side – 10'	Rear – 20'	

- ★The front of a property is where the property is accessed from a public road.
- ★Measurements are taken from property lines. Know your property lines. Fences may not be a property line.
- ★A corner lot is determined as the sides abutting the road/street.

**PUBLIC UTILITY SETBACKS:** You MAY be subject to public utility setbacks such as electricity, propane/natural gas cable and telephone lines. Contact your individual vendor for more information.

## CONEJOS COUNTY LAND USE CONSTRUCTION FEES

The following *non-refundable* fees are for issuance and administration of construction permits. Fees are higher if construction is begun before a permit is obtained (POST FEE). If construction is not completed within one year, the permit must be renewed at the end of each 12-month period. Fees are charged per project (\$100.00 Garage; \$50.00 Shed; \$50.00 re-roofing.) All fees are payable to the **CONEJOS COUNTY TREASURER**.

### **New Residential Dwellings, DW Manufactured/Mobile Homes, Modular Homes** (\$100.00 for every 1000 square feet over 2000)

Up to 2,000 square feet	<input type="checkbox"/> Pre-construction \$300.00	<input type="checkbox"/> Post-construction \$600.00
2,001 to 3,000 square feet	<input type="checkbox"/> Pre-construction \$400.00	<input type="checkbox"/> Post-construction \$800.00
3,001 to 4,000 square feet	<input type="checkbox"/> Pre-construction \$500.00	<input type="checkbox"/> Post-construction \$1,000.00
4,001 to 5,000 square feet	<input type="checkbox"/> Pre-construction \$600.00	<input type="checkbox"/> Post-construction \$1,200.00
5,001 to 6,000 square feet	<input type="checkbox"/> Pre-construction \$700.00	<input type="checkbox"/> Post-construction \$1,400.00

**Single Wide Mobile Homes (1976 & Newer):**  Pre-Construction \$100.00  Post-Construction \$200.00

### **Accessory Structure/Building (Garage/Shop/Storage Unit/Barn) ENCLOSED ON ALL SIDES**

	<b>Pre-Construction:</b>	<b>Post-Construction:</b>
<input type="checkbox"/> 120–400 Square Ft	<input type="checkbox"/> \$50.00	<input type="checkbox"/> \$100.00
<input type="checkbox"/> 401–1000 Square Ft	<input type="checkbox"/> \$100.00	<input type="checkbox"/> \$200.00
<input type="checkbox"/> 1001-2000 Square Ft	<input type="checkbox"/> \$150.00	<input type="checkbox"/> \$300.00
<input type="checkbox"/> 2001 Square Ft and larger	<input type="checkbox"/> \$200.00	<input type="checkbox"/> \$400.00

### **Accessory Structure/Building (Carport/Hay Shed/Gazebo/Shed-three sided building) NOT ENCLOSED**

Pre-Construction \$100.00  Post-Construction \$200.00

### **Additions/Expansion to residential, commercial & accessory buildings (ENCLOSED)**

Pre-Construction \$150.00  Post-Construction \$300.00

### **Additions/ Expansion (Decks/Porches/Veranda/Lean-to/Greenhouse) NOT ENCLOSED**

Pre-Construction \$50.00  Post-Construction \$100.00

### **Other construction permits**

	<b>Pre-Construction</b>	<b>Post Construction</b>
<input type="checkbox"/> Roofing/Re-roofing	<input type="checkbox"/> \$50.00	<input type="checkbox"/> \$100.00
<input type="checkbox"/> Commercial/Business Structure	<input type="checkbox"/> \$500.00	<input type="checkbox"/> \$1,000.00
<input type="checkbox"/> HORCA - RV Accessory Structure	<input type="checkbox"/> \$200.00	<input type="checkbox"/> \$400.00
<input type="checkbox"/> Temporary Buildings/Structures:	<input type="checkbox"/> \$100.00	<input type="checkbox"/> \$200.00
<input type="checkbox"/> Permit Renewal/Extension	<input type="checkbox"/> \$55.00	

### **SEPTIC SYSTEM PERMITS:**

	<b>Pre-Construction</b>	<b>Post Construction</b>
New System:	<input type="checkbox"/> \$250.00	<input type="checkbox"/> \$500.00
Repair/Replace Tank or Leach Field:	<input type="checkbox"/> \$125.00	<input type="checkbox"/> \$250.00
Evaluation/Inspection:	<input type="checkbox"/> \$125.00	
Septic Installer/Cleaner License:	<input type="checkbox"/> \$25.00	

**PHYSICAL ADDRESS ASSIGNMENT:**  \$35.00 **PHYSICAL ADDRESS SIGNS:** (Please ask Land Use Staff for more information.)

**COUNTY ROAD ACCESS PERMITS:**  \$50.00

**UTILITY IN RIGHT-OF-WAY PERMITS:**  \$250.00 (Deposit is also required.)